

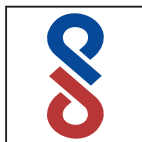

# Product Specification

FL3528-CV24240-CCTP15

| Made by | Checked by | Date      | Product   |
|---------|------------|-----------|-----------|
| Tony    | Ada        | 2022.1.19 | Led strip |



## Company Profile :

Based in Shenzhen, PRC. Since 2009, Shenzhen Easing Home Opt-electronics Co Ltd is passionate about lighting and technology, and has rapidly grown to be a leading supplier for LED strip, LED profile, LED linear light, LED silicon neon flex and other relative accessories to clients for full range product & service. Currently we Easinghome LED has a professional lighting design team of engineers and a number of automated production lines.our products have been sold to more than 80 countries and areas. We are continuing to develop the new energy conservation and environment protection, high efficient product for you.

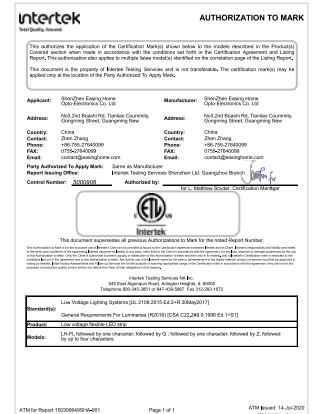

Shenzhen Easing Home Opt-Electronic .,Co Ltd.

① ADD 1: No 196, Tangtou Rd, Shiyan Street, Baoan District, Shenzhen, Guangdong, China

ADD 2: Building No.5, 2nd Baoshi Road, 2nd Tianliao Industrial Area, Gongming Street,  
Guangming New District, Shenzhen City 518106, Guangdong Province, China

www.easinghome.com    www.ledlits.com    www.ledhomex.com

contact@easinghome.com

86-0755-27640099



## SMD 3528 240LED CCT flexibility light strip

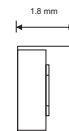
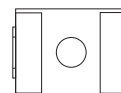
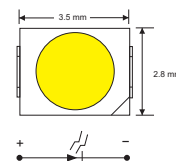

## Light Source

|                   |  |
|-------------------|--|
| Wire inside chips | 99.99% purity golden (1.0um or above diament)  |
| Chip size         | Big size chip with high output lumen   |
| Chosphor powder   | Mitsubishi or Intermatrix phosphor powder  |
| Chip brand        | Epistar or brand chip  |
| LED lead frame    | 100% purity copper LED lead frame  |
| PCB               | 35U cooper PCB/ double side PCB/ back side of PCB is protection layer                            |
| Bin code          | One order, one small bin code only, and ledhome can Promise you sereral orders from same one bin |
| 3M tape           | 300P genuine 3M tape /3M VHB tape  |
| Age testing       | Ledhome strip take at least 8hours aging-test  |
| QC checking       | 3 times QC checking(SMT + PCB jointing+ after aging testing) before packing                      |

## Technical Drawing

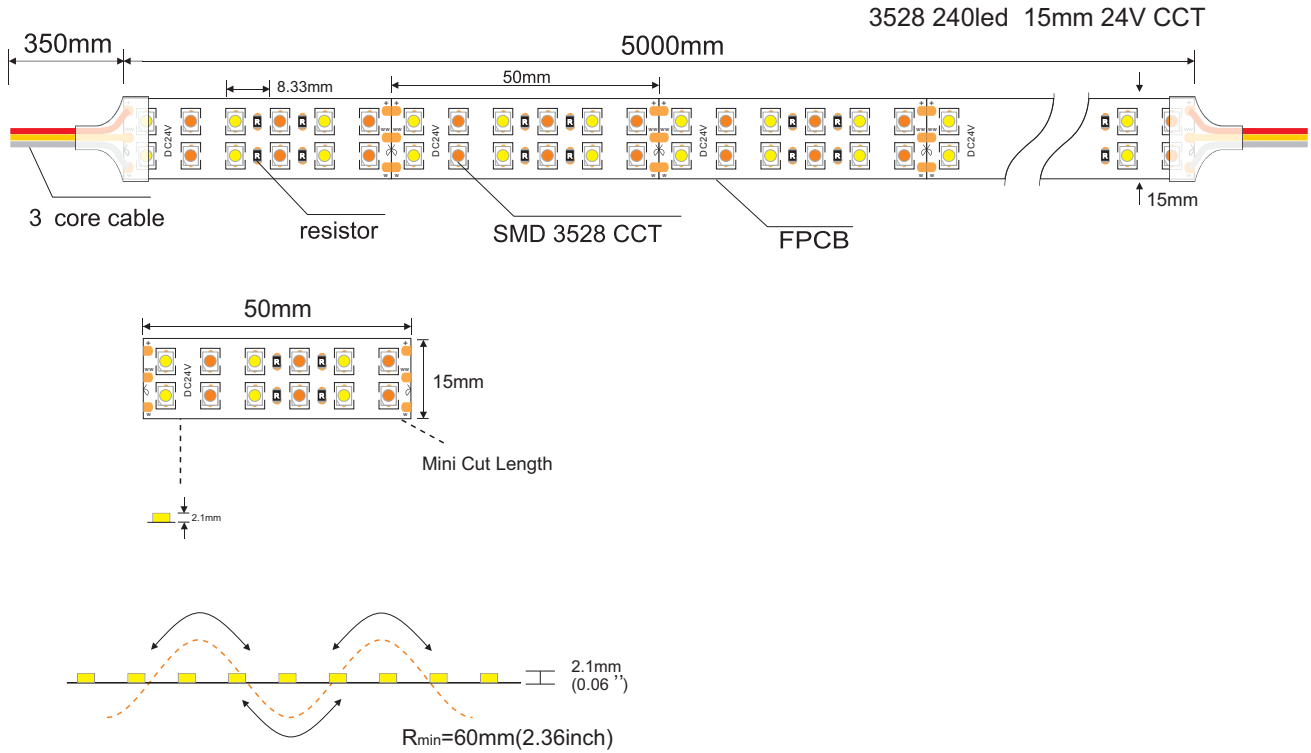

## Basic Parameter

| P/N                     | LED QTY (PCS/M) | Voltage | Power W/m | Color      | PCB size (mm) | Lumen lm/w | Lumen CRI>90 |
|-------------------------|-----------------|---------|-----------|------------|---------------|------------|--------------|
| FL3528MIX-CV24240-15CCT | 240             | CV24V   | 9.6W      | 1800K      | 15            | 81         | 747LM        |
|                         |                 |         | 9.6W      | 4000K      |               | 93         | 1010LM       |
|                         |                 |         | 19.2W     | 1800+4000K |               | 87         | 1749LM       |

Note: pink, purple, other color customized, pls further contact.

All above parameters were given based on naked strip without additional heat sink.

## Product Parameters

### Spectroscopic standard

Ensure customers to get the same bin for different orders by using CIE(X,Y) coordinate spectrometer

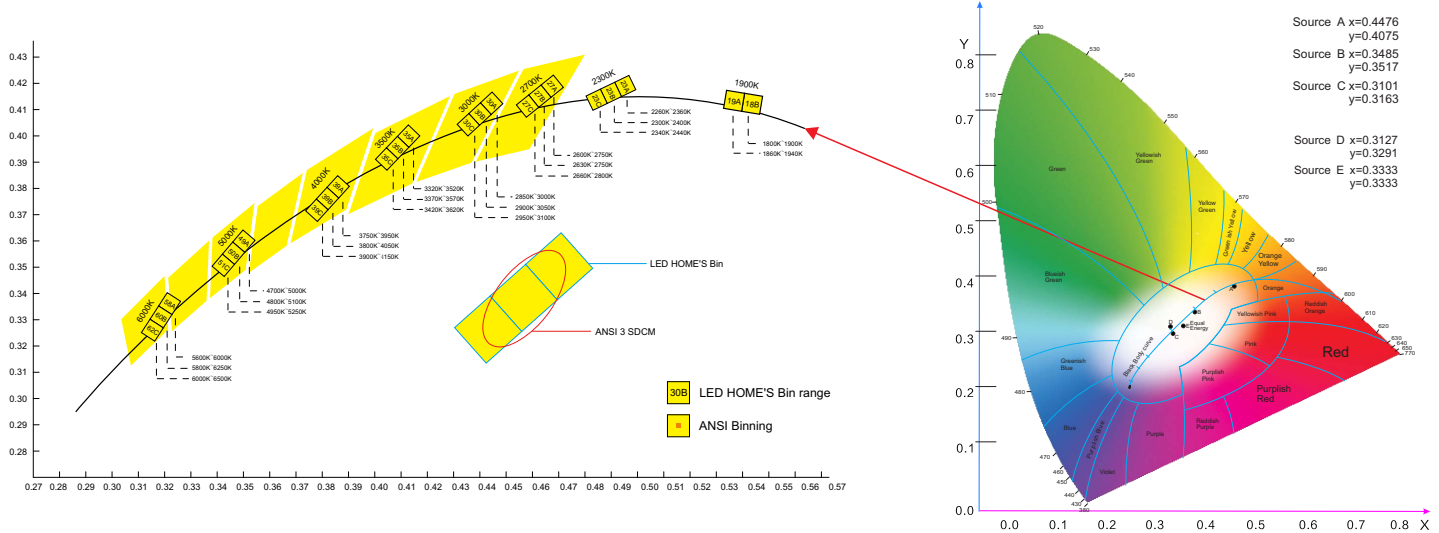

## Product Specification

|                        |                            |                         |                              |
|------------------------|----------------------------|-------------------------|------------------------------|
| Item:                  | 3528 led strip             | Driver:                 | External led driver          |
| Qty LED beads:         | 240leds/m                  | Mains voltage (V):      | CV24V                        |
| Color:                 | CCT                        | Control gear type:      | Constant voltage driver      |
| PCB width:             | 15mm                       | Ref:                    | Meanwell                     |
| Light controller type: | 0-10V/1-10V/DMX/DALI/Triac | Emergency availability: | /                            |
| Light decay:           | 2% @ 6000Hours             | Chip:                   | Epistar or other brand chips |
| Operating temperature: | -25~45 degree              | Light emission:         | 120°                         |
| Lifetime               | (Lm80) 50000 HRS @45degree | Deviation (SDCM)        | 3step MacAdam ellipse        |
| Mounting               | 3M adhesive tape           | BIN:                    | One bin only                 |
| Max running length:    | 10meter (two side feed)    | Warranty:               | 5 years                      |
| Luminaire in:          | CLASS II/III               |                         |                              |

## Light Distribution Curve [Unit:cd]

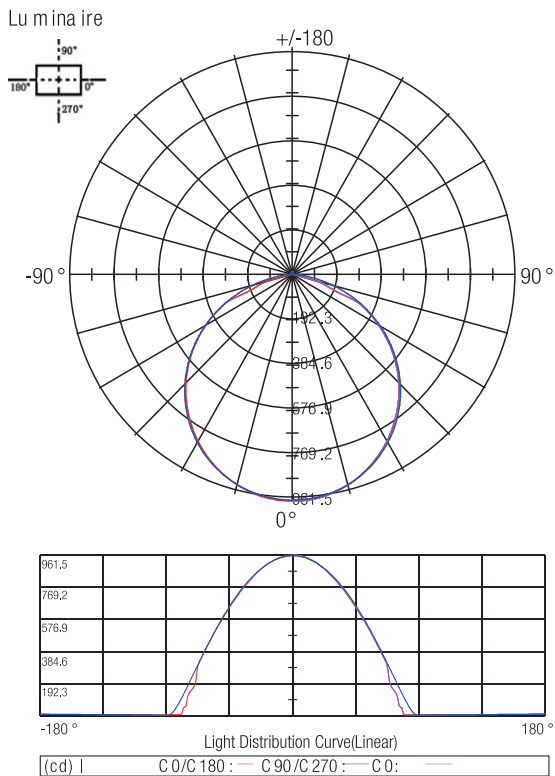

## Lux-Distance Curve

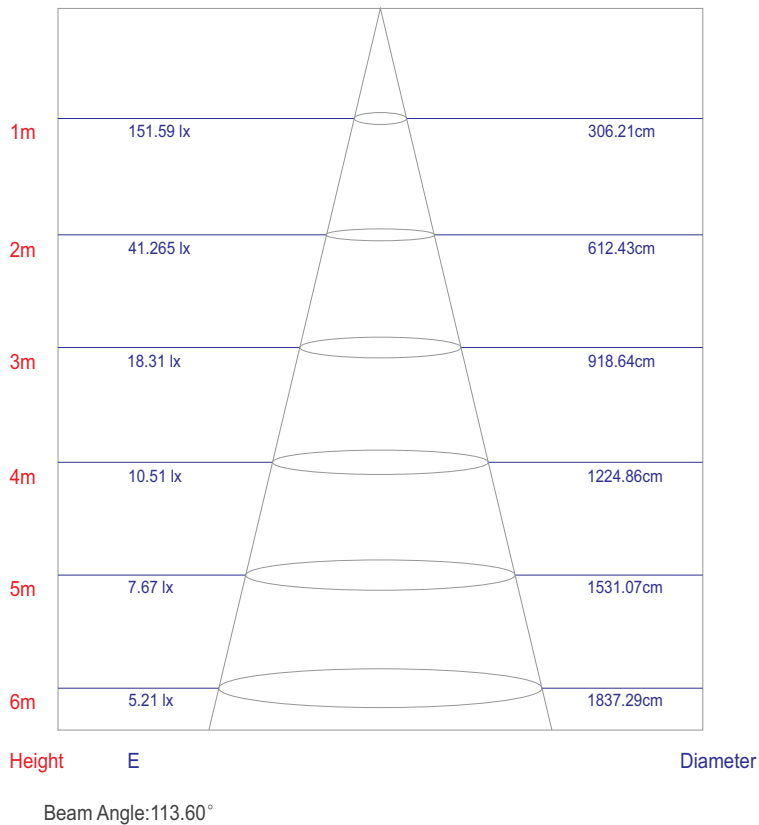

## Colour Rendering Index

| R1 | R2 | R3 | R4 | R5 | R6 | R7 | R8 | R9 | R10 | R11 | R12 | R13 | R14 | R15 |
|----|----|----|----|----|----|----|----|----|-----|-----|-----|-----|-----|-----|
| 97 | 97 | 98 | 99 | 97 | 94 | 95 | 96 | 94 | 95  | 96  | 84  | 97  | 99  | 98  |

## LED Strip Solution

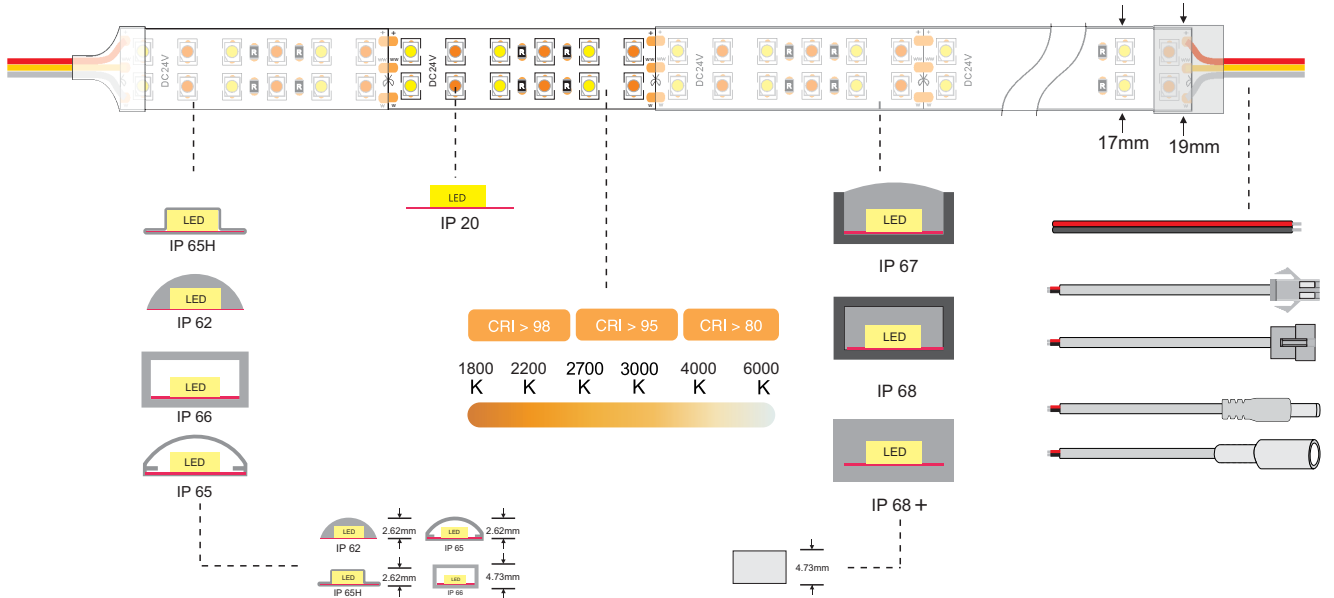

## One end feed

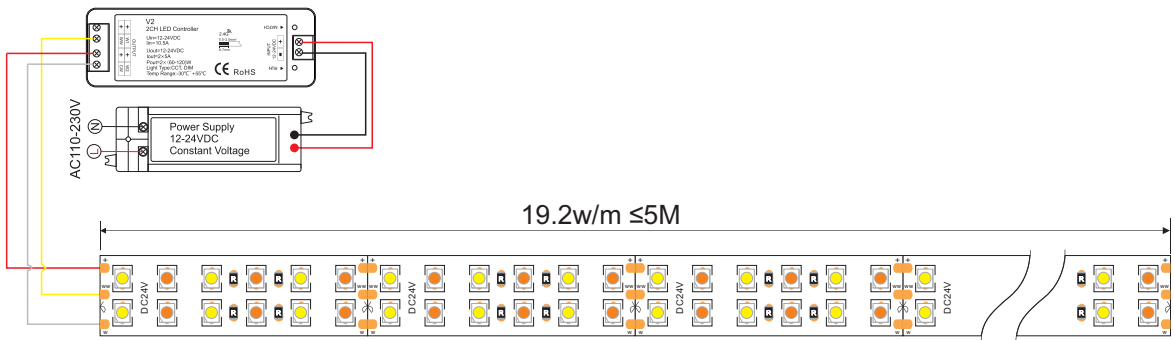

## Two ends feed

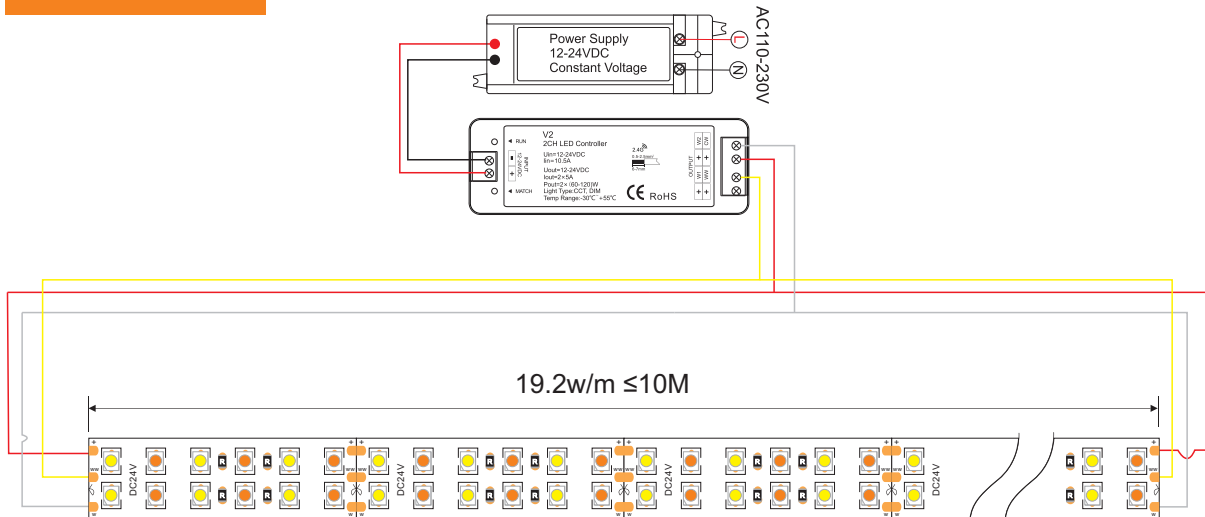

## IP Level Diagram

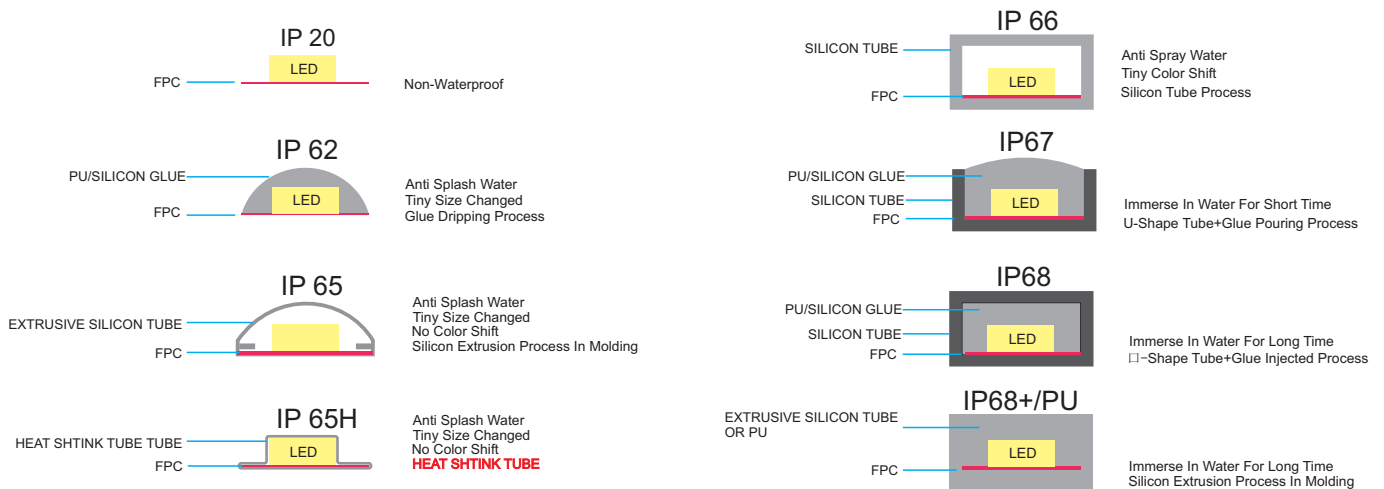
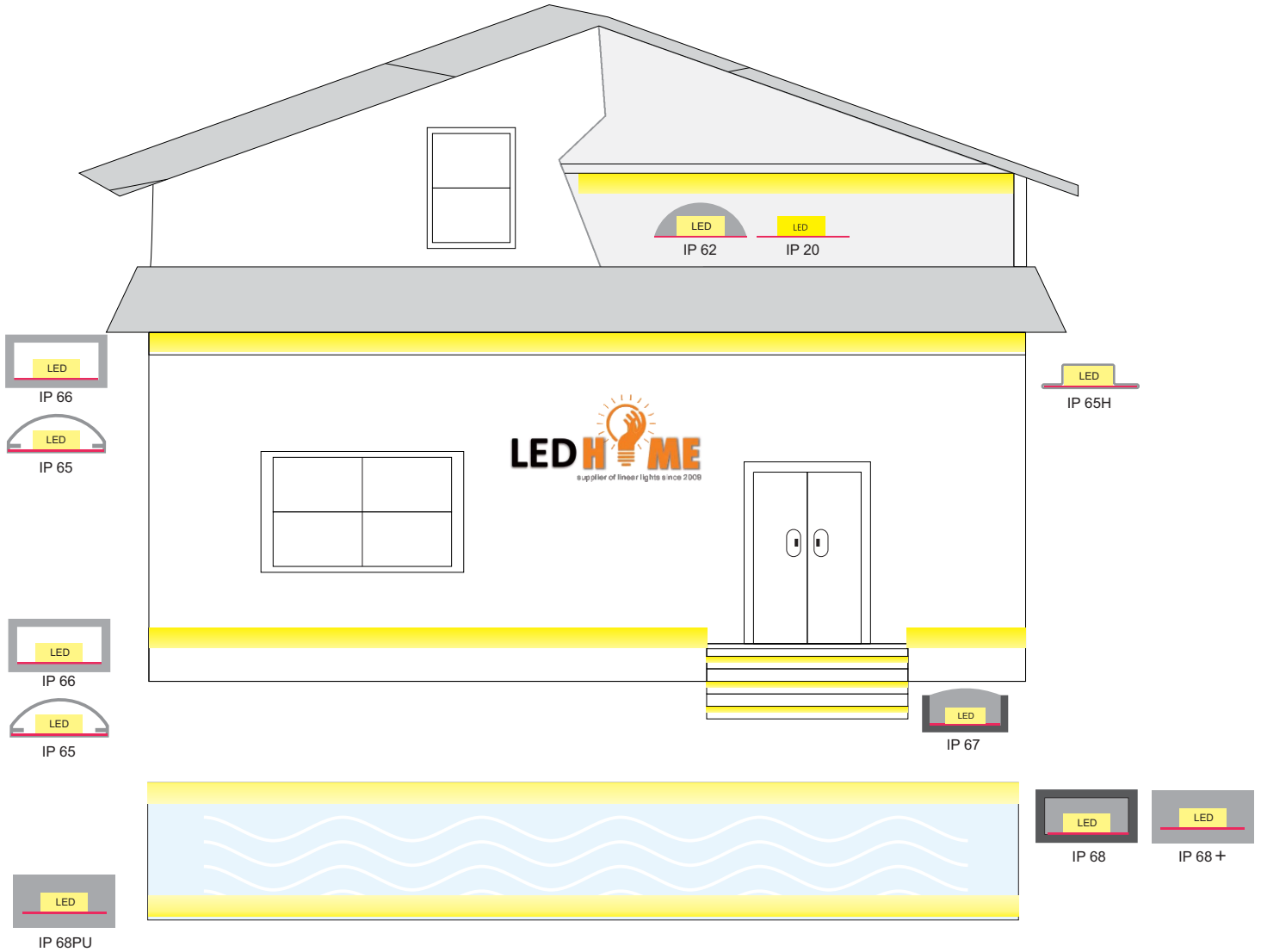



## Installation Diagram:

### 3. connection with CCT controller

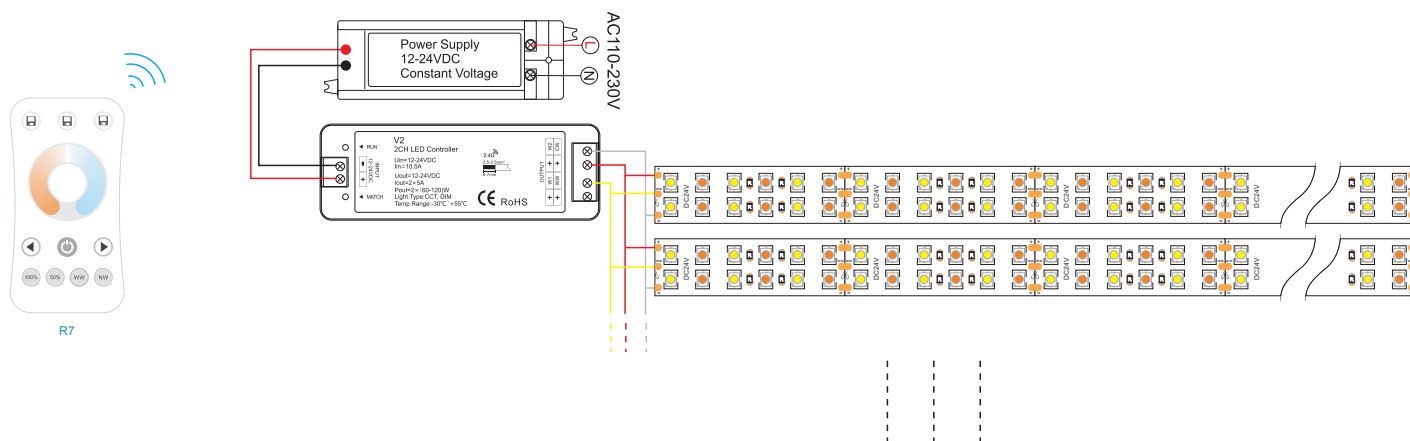

## Installation

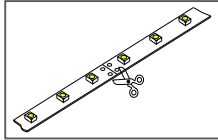

1. Cut in specific location

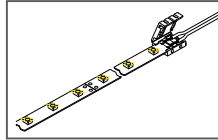

2. Put the PCB in the space between clip and connector, make the clips exactly aim at welding point

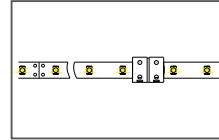

3. Close the cover of connector

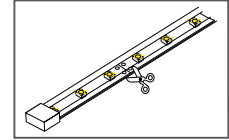

1. Cut in specific location

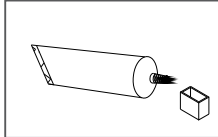

2. Infuse the gel in the end cap

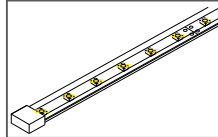

3. connect the end cap and wait for air drying

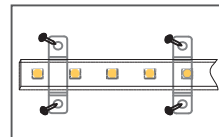

1. Install with clips

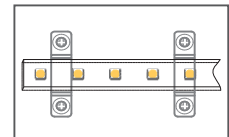

2. Fix with screws

### 1. STRIP TO STRIP INSTALLATIONS

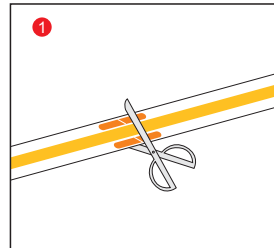

1. Cut the light strip from the cut point

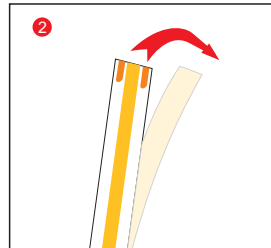

2. Tear off the 3M glue behind the light strip

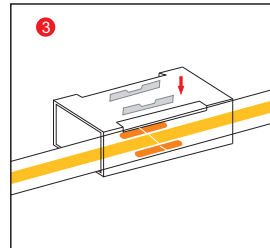

3. Put the COB light strip inside the crystal connector and press the iron piece down.

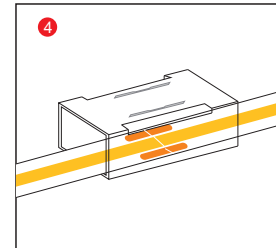

4. Test the light strip after pressing down the iron sheet, the installation is complete

### 2. STRIP TO WIRE INSTALLATIONS

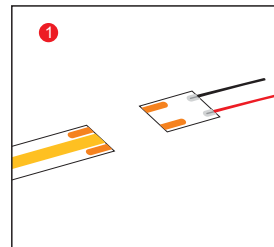

1. Prepare the dedicated cable for the crystal connector

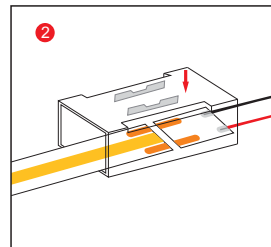

2. Put the light strip and cable into the crystal connector and press down the iron piece

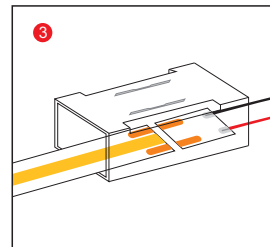

3. Installation is complete, test the light strip

## Accessories:

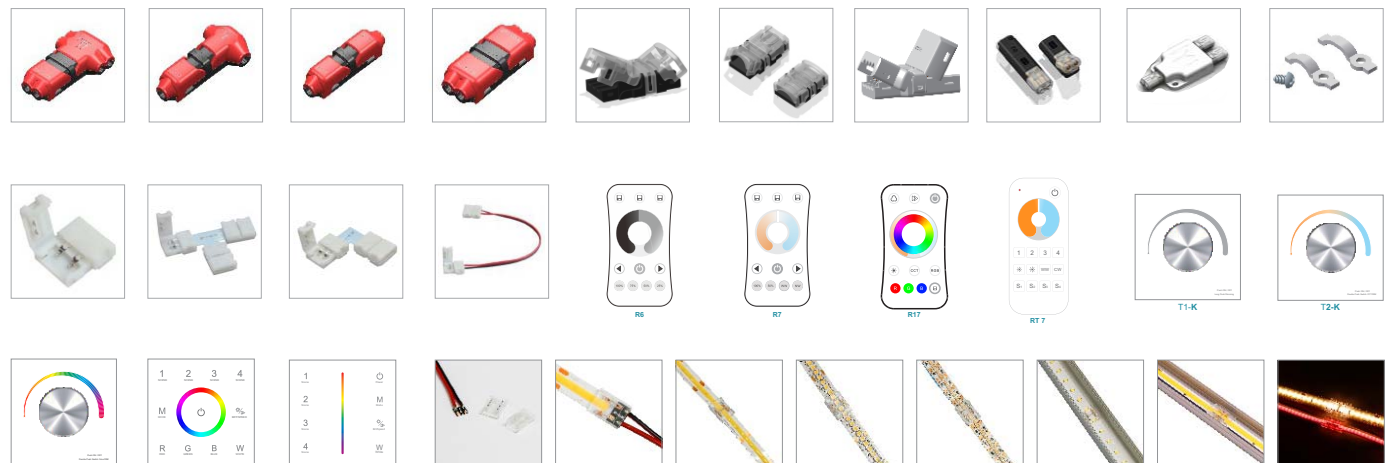

## Cautions



When install the led strip,please note the installation technique.The led strip can be bent,but not distorted,as shown below.

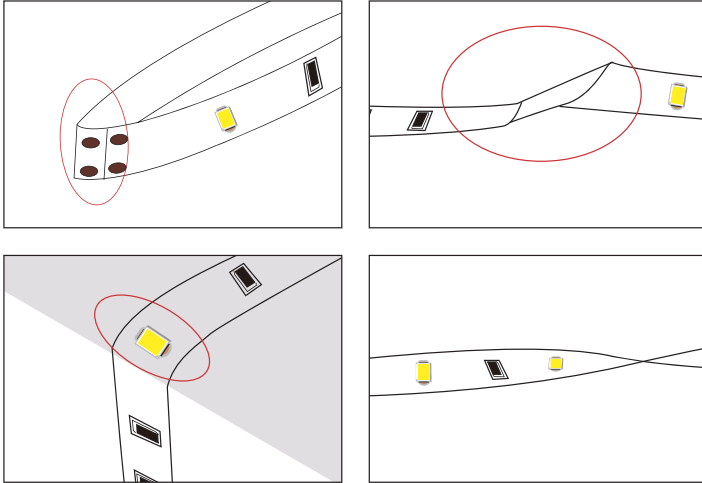

Distortion(Wrong)

LED strips are low voltage products,you must use the power supply(transformer).Please don't connect the led strip directly to the AC 110v or AC 220v,otherwise it will burn out the LED strips.

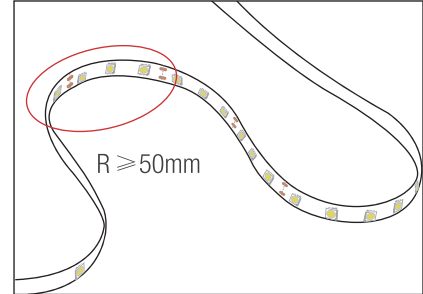

Bend(Right)

Clean up the installation surface,it will ensure the reliability of the adhesive,The electrical connection process must be operated by a professional person.

## Packing :

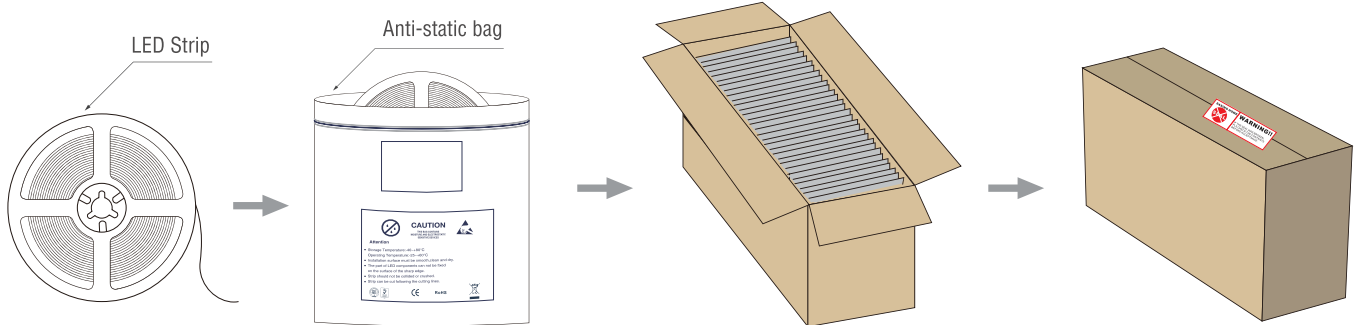

## Notice:

- 1、 Please apply different IP rate products according to different environment conditions;
- 2、 Adopt suitable power supply to match the LED strips. Power is 20% bigger than max power of LED strips to ensure long time performance of power supply;
- 3、 Do not install it when power is on. Before powering on, please make sure the wiring is correct;
- 4、 Avoid privately changing or damaging the circuit or other component on the strip;
- 5、 Avoid scrape or bending during installation, it might be damaged with non repairable status;
- 6、 Strip linked in over long length would lead to problem of overload or uneven brightness;
- 7、 To protect your eyes, do not stare at the light for a long time while it's illuminated;
- 8、 Only professional personnel can install, dismantle and repair;
- 9、 Choose different connectors and controllers according to your different strip.